

PURE

Insulated Metal Panel

With smooth, unembossed steel facings, TrueCore's PurePanel is ideal for interior cleanroom environments such as data centers, pharmaceutical manufacturing and packaging plants, semi-conductor manufacturing lines, and indoor growing facilities. Our PurePanel minimizes particle generation and exhibits excellent humidity- and temperature-control, making it fit for interior wall, partition, and ceiling applications.

Specifically designed to mitigate dust accumulation, inhibit microbial growth, and prohibit moisture, you can depend on TrueCore's PurePanel for your most sensitive of environments.

SIDE JOINT

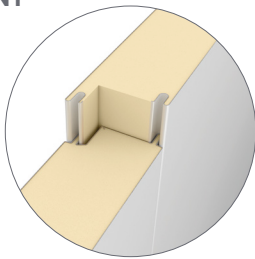

PANEL PROFILE AND CROSS SECTION

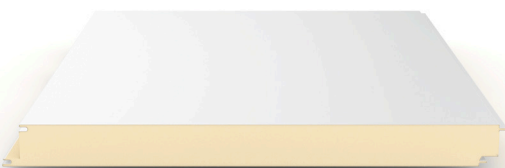

EXTERIOR AND INTERIOR PROFILE & TEXTURE

Flat profile with unembossed surface

The unexposed side or exterior facing is also available with Mesa profile and stucco embossed texture.

EXTERIOR FACINGS

26, 24, 22 Ga. G-90 galvanized steel or AZ50 aluminum coated steel

INTERIOR FACINGS

26, 24, 22 Ga. G-90 galvanized steel or AZ50 aluminum coated steel

EXTERIOR AND INTERIOR COATINGS

Polyester
Siliconized Polyester (SMP)
Fluoropolymer (PVDF)
Flurothane* II, IV, V
PVC Plastisol

WIDTH

44", 40"

LENGTH

8'-0" to 40'-0"

The maximum length for ceiling panels is 16'-0".

THICKNESS

2", 3", 4", 5", 6", 8"

CORE

Foamed-in-place Class 1 rated polyisocyanurate

JOINT

Double Tongue and Groove for concealed fastening

R-VALUE

R-8 per inch of thickness (nominal)

Note, PurePanel is available for interior use only.

**Flurothane is a registered trademark of The Sherwin-Williams Company*