

DURA

Insulated Metal Panel

TrueCore's DuraPanel is designed for high-traffic zones and process areas where the interior facing demands added impact resistance. Reinforced with 3/8" oriented strand board (OSB) sandwiched between the interior metal face and the foamed-in-place polyisocyanurate core, our DuraPanel significantly reduces potential for severe damage.

When you need extra durability, choose TrueCore's DuraPanel.

SIDE JOINT

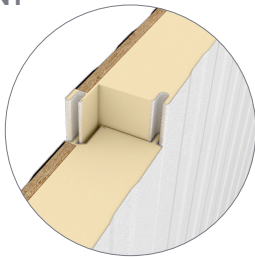

PANEL PROFILE AND CROSS SECTION



EXTERIOR AND INTERIOR PROFILE & TEXTURE	Mesa profile with non-directional stucco embossing
EXTERIOR FACINGS	26 Ga. G-90 galvanized or AZ50 aluminum coated steel
INTERIOR FACINGS	26 Ga. G-90 galvanized or AZ50 aluminum coated steel
EXTERIOR COATINGS	Siliconized Polyester (SMP) Fluoropolymer (PVDF) Flurothane* II, IV, V
INTERIOR COATINGS	Polyester Siliconized Polyester (SMP) Fluoropolymer (PVDF) Flurothane* II, IV, V PVC Plastisol
WIDTH	44", 40"
LENGTH	8'-0" to 30'-0" standard <i>Contact TrueCore for information and pricing on longer lengths.</i>
THICKNESS	4"
CORE	Foamed-in-place Class 1 rated polyisocyanurate
JOINT	Double Tongue and Groove for concealed fastening
R-VALUE	R-8 per inch of thickness (nominal)

**Flurothane is a registered trademark of The Sherwin-Williams Company*